

4 in 1

.....> welcome to the crazy world of parenting.  
take a deep breath....

note:

PG *parental* guidance required

NB baby not included



.....> inline™ vibe survival guide

adapt™ survival!™ <

inline™ buggy

vibe.....undressed! <

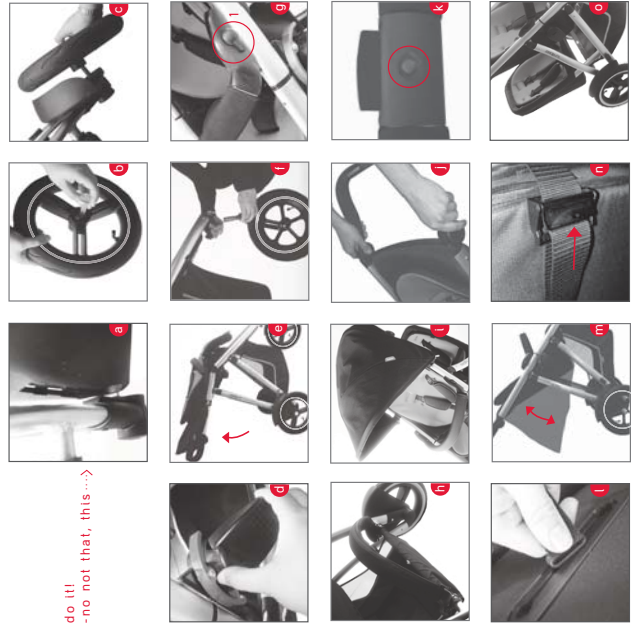

.....> do it!  
-no not that, this.....>

> that's it!

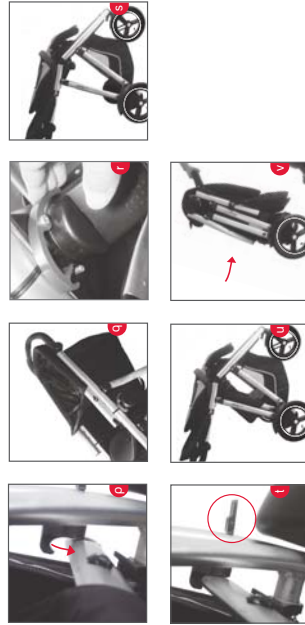

## vibe instructions

assembling your new philtedix inline®-vibe is effortless and tool-free, just follow these simple steps and in 4.25 minutes you'll be off.

### bits & bolts

the red numbers below refer to buggy parts indicated inside the back flap of this guide.

1. intelligent handle brake
2. intelligent handle
3. wrist strap
4. double kit (sold separately)
5. fold lock
6. double kit harness
7. rear guards
8. rear axles
9. rear wheels
10. sunhood
11. back flap
12. slide lock harness
13. pull bar
14. red safety lock
15. footwell
16. swivel lock
17. double kit spring lock
18. front wheel

### safe & sound

we've attained the following safety standards:

- EN 1889:2005
- AS/NZS 2089:2000
- ASTM F833-07a

### wheeling & dealing

- keep tyres inflated to 22PSI max.
- a attach rear guards by sliding them down track at base of wheel frame. to remove rear guards, pull bottom edge of guard outwards and slide it up and out of track.
  - b insert axles into rear wheels (from side without brake disk).
  - c to attach rear wheels: depress silver axle hub and insert wheel axle into buggy axle housing.
  - d to unhold frame: open fold lock handles.
  - e open and extend buggy, close fold lock handles.
  - f to attach front wheel: fully extend swivel lock knob and insert wheel rod into buggy frame, as shown; release swivel lock knob and check wheel is in place for use.
  - g to place front wheel in swivel position: rotate 90° until swivel lock knob clicks into place (wisely extended).
  - h to lock swivel wheel: rotate 90° until swivel lock knob clicks into place and is no longer extended.

### pull bar

- g slot pull bar into upper set of sockets on centre front of buggy frame.
- h to remove: rotate bayonet release levers upwards, slide pull bar up frame, lift and remove pull bar.

when double kit is attached to front of buggy (baby & toddler position), remove pull bar and store in moulded sockets on rear cross bar, as shown.

### sunhood

- i your vibe will arrive with its sunhood attached; to remove: place thumbs on plastic clips and rotate snap attachments outwards, remove sunhood from frame.
- n to re-attach: lay sunhood on frame facing down towards front end of buggy, use palms of hands to snap attach plastic clips onto frame. rotate sunhood backwards, slide snap attachments up/down frame to alter headroom.

### intelligent handle adjustment

- j to alter handle height: depress both black buttons located on inside of handle and rotate handle into desired position.

### intelligent handle brake

- k press small red button for park, press large black button for go.

### harness adjustment

- l under padded seat, turn harness strap retainer to vertical position and slide to either top, middle, or lower setting, lock in place by turning strap retainer to horizontal position.
- m breastplate should fit snugly on baby's chest, allowing you to fit 2 average sized fingers between straps and baby; harness strap tension can be adjusted using clips located at shoulder height.

### ups & downs

- m vibe seat can be adjusted to any ergonomic position from upright through to lie-flat.
- n to adjust seat for recline: release seat adjustment clip on seat back, recline seat into desired position, secure seat adjustment clip.
- o adjust seat for lie-flat position: recline seat fully and undo zips on either side of front seat pad.

### double buggy

- o double kit on back: fit double kit into moulded plastic sockets on rear cross bar and ensure bayonet fitting is secure. lift double kit back ensuring spring locks are engaged. load heavier toddler in front seat first, then place lighter toddler in double kit

- at back, always unload rear, toddler first.
- warning:** never place a child in double kit without a child in front seat.
- p to remove: double kit from rear rotate bayonet release levers upwards, slide double kit backwards, lift and remove.
  - q attaching double kit to front: place vibe seat in lie-flat position. remove pull bar from front of vibe and fit double kit into front frame sockets.
  - r double kit can fit in either set of sockets, to remove from front of buggy: rotate bayonet release levers upwards, slide double kit up frame, lift and remove.

**note:** double kit has a recline feature. to activate: undo zips that run around back of seat.

### folding

- r to prepare for folding: rotate handle into upper most position and ensure front wheel is in swivel mode, release child harness, release fold locks.
- s note: vibe can be folded with double kit attached to front or rear.
- r folding without double kit on: depress red safety lock.
- s fold so that buggy nose cone and handle come together, ensure front wheel lies flat against buggy, lock frame and secure by closing fold locks.

### vibe moving parts

excessive wear can reduce effectiveness and safety, parts may need periodic lubrication. inspect essential components for: fraying – especially webbing straps and safety harnesses; wear – locks, snap fasteners; tyres, plastic parts, zips and moving parts, safety locks must not be loose.

### rights & remedies

\*consumers may have extra rights in some countries or states. our products are warranted against defects in materials and workmanship for one year from the date of purchase. if the product has a manufacturing fault we will repair it for free, if not practical to repair it, we will, at our discretion, replace the part in question. if the product fails due to wear and tear, accident, neglect or negligence, or is outside the warranty, we will happily repair it for a reasonable charge.\*

**who is covered?** original purchaser buying product from an authorised dealer, proof of purchase is required.

**what is covered?** workmanship or materials that are deemed faulty, providing buggy has at all times, been used in normal conditions, in accordance with the instructions, and been properly maintained.

**what is not covered?** second hand product, modified product, poorly maintained product, normal wear, fading and fabric cuts, improper

## Warnings!

keep instructions with your buggy for future reference. injury may result from improper use or not following all safety precautions.

**warning** never leave children unattended in the buggy, it may be dangerous. take extra care with any child asleep in the buggy.

**warning** ensure that all locking devices are engaged before use.

**warning** any load attached to the handle affects the stability of the vehicle. do not hang luggage or carry extra children on the buggy.

do not allow a child to stand on the seat. do not carry extra weight over that allowed by the instructions; this may make the buggy unstable. do not place more than 3kg/7lbs in the parcel tray.

**warning** always use the safety harness to avoid serious injury from falling or sliding out. always ensure all safety harness straps and ensure

- note:** sunhood, pull bar, and double kit can remain attached.
- l folding with double kit on: release double kit spring locks as shown.
  - m do not take double kit out of moulded sockets.
  - n lift double kit towards front of buggy, lift front seat up and slide double kit underneath, close fold/safety locks.
  - v folded buggy can be manoeuvred using pull bar as handle.

### add & adapt

other products available for vibe:

### buggy covers

- single and double storm cover
- single and double mesh cover

### buggy beds and liners

- buggy cocoon
- snuggle & snooze sleeping bag

### buggy storage

- up & away travel bag
- base bag
- diddle bag

**warning** double kit is not recommended for children under 6 months.

**warning** care should be taken if buggy is used on stairs or escalators.

**warning** the buggy should not be used near an exposed flame.

**warning** ensure that fingers are kept well clear of folding mechanism when folding buggy.

**warning** the buggy is not suitable for running, skating, horse riding, water skiing, acrobatics or similar activities. it is not a flotation device.

### enjoy!

around your wrist when using buggy.

**warning** do not place a child in the rear seat of a buggy without a heavier child being in the front seat. do not modify the buggy or use accessories not designed for the buggy, they may be unsafe.

it's correctly fitted and adjusted to secure the child firmly, make sure children are clear before folding, erecting or adjusting the buggy.

if required, use the D-rings on the waist strap to attach a safety harness.

**warning** apply brakes when parking the buggy, apply brakes when loading or unloading children. a buggy in the single or baby & toddler configuration is intended for children up to 4 years or maximum weight of 40kg/88lbs and height of 1.1m or 3.3 feet. in the double configuration the recommended max load is 25kg/55lbs in front seat and 15kg/33lbs in rear seat.

**warning** always place wrist strap around your wrist when using buggy. **warning** do not place a child in the rear seat of a buggy without a heavier child being in the front seat. do not modify the buggy or use accessories not designed for the buggy, they may be unsafe.

# phil&ted's

# vibe folding instructions

Please read ALL the instructions and look CAREFULLY at the pictures. Trust us, this will really help!!

**Folding without double kit attached, or with the double kit on front of the buggy in folded/newborn position.**

**Note:** The double kit must be attached to the top set of holes if you wish to leave it on while folding the buggy, see image b.

**Note:** If you would like to tow the buggy like a trolley once folded, leave the brake off and the bumper bar attached. (Super useful in airports and the like)

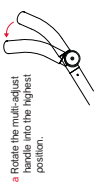

**a** Rotate the multi-adjust handle into the highest position.

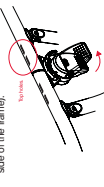

**b** Open both of the black hinge locks. (Those paddle things on either side of the frame).

**c** Make sure the front wheel is in swivel mode and the child harness is undone.



**d** Push the main seat base (fabric seat) upward until it is fully inverted.



**e** Ensuring that the face of the plastic bit, shaped like an upside down 'J', is fully inverted, depress the red safety latch and fold the frame together.

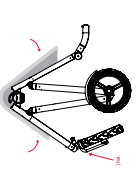

**Note:** When fully folded the front wheel should rest on the buggy handle with the bar facing outwards. (The bar is the black plastic bit, shaped like an upside down 'J', connected to the front wheel axle).

**f** Lay the buggy on the ground with the handle facing upwards and close both of the black hinge locks. (those same paddle things).

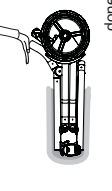

done!

## Folding with the double kit in rear position

**Note:** If you would like to tow the buggy like a trolley once folded, leave the brake off and the bumper bar attached. (Super useful in airports and the like)

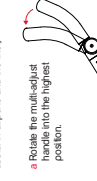

**a** Rotate the multi-adjust handle into the highest position.



**b** Open both of the black hinge locks. (Those paddle things on either side of the frame).

**c** Make sure the front wheel is in swivel mode and the child harness is undone.

**d** Open the double kit into springs, allowing the double kit to pivot on the cross bar.

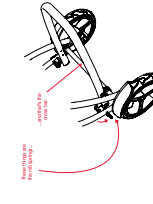

**e** Push the main seat base (fabric seat) upward until it is fully inverted. Push the inverted seat bases.

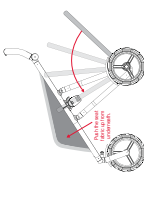

**f** Ensuring that the parcel tray is folded upwards at the centre, depress the red safety latch and fold the frame together.

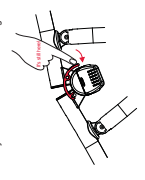

**Note:** When fully folded the front wheel should rest on the buggy handle with the bar facing outwards. (The bar is the black plastic bit, shaped like an upside down 'J', connected to the front wheel axle).

**g** Lay the buggy on the ground with the handle facing upwards and close both of the black hinge locks. (those same paddle things).

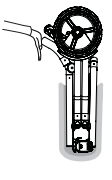

done!

# phil&ted's

# vibe sunhood instructions

Please read ALL the instructions and look CAREFULLY at the pictures. Trust us, this will really help!!

**To attach**

**a** Position the vibe sunhood above the vibe buggy frame ensuring that:

- 1 The top of the sunhood is clear of the handle.
- 2 The zip is facing upward.
- 3 The sunhood frame clip tab is on the top of the buggy frame.

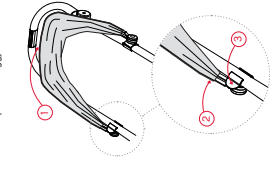

**b** The hood attaches to the buggy frame using the two clips (on either side of the hood). We'd suggest you attach the underside of the clip first.



**c** Slide the hood up or down the buggy frame, to the height that best suits you.

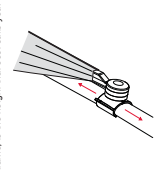

**d** Open the sunhood into desired position.

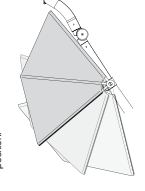

**To remove**

**e** Pull the sunhood clip tab outward and away from the buggy frame.

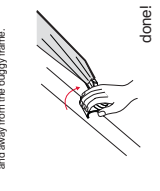

done!

## Unfolding with the double kit in rear position.

**e** Repeat unfolding instructions a-c.

**f** Pull double kit out.

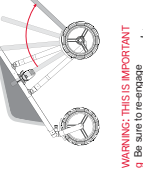

**WARNING: THIS IS IMPORTANT**

**g** Be sure to re-engage the rnto springs.



**h** Push the main seat base (fabric seat) down and GO GO GO!!

**c** Close both of the black hinge locks. (Those paddle things on either side of the frame).

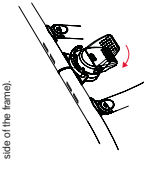

**d** Push the main seat base (fabric seat) down and GO GO GO!!



## Unfolding without double kit attached, or with the double kit on front of the buggy in folded/newborn position.

**a** Open both of the black hinge locks. (Those paddle things on each side of the frame).

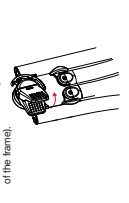

**b** Unfold the frame (the red safety latch will be in the up position when the buggy is fully unfolded).

**Note:** Sometimes the frame will lock and needs to be pushed together to release.

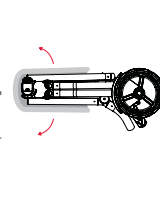

send 102 - 112 daniel at newtown wellington nz  
visit www.phil&ted.com  
01 +64 4 380 0833  
02 +64 4 380 0137

© Phil and Ted's Most Excellent Buggy Company Ltd 2007.  
We (Phil and Ted's Most Excellent Buggy Company Ltd) own the intellectual property rights in our brands, designs and inventions featured in this publication. These include, without limitation, the phil&teds, adek®/newborn, & INLINE trade marks and INLINE DOUBLE BUGGY shape. We actively pursue people who infringe our intellectual property.

# phil&ted's



888 888 8888

ENTER THE TRAVEL BAG GIVING GUIDE

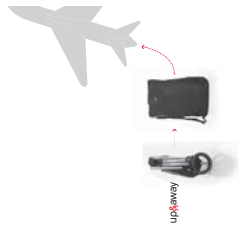

upaway

